

PITT-EASY[®]



**Sybron
Implant Solutions**
Sybron Dental Specialties

PITT-EASY®

Unique Implant Design

Exceptional Versatility
Long-Term Success

Pitt-Easy® implants combine the properties of a tapered implant body and the advantages of a self-tapping expansion thread system. The unique implant design facilitates quick and uncomplicated insertion and allows for immediate stability in all bone types. The system's multiple diameters, lengths and prosthetic options provide an optimal solution for virtually any indication.



Surgical Kit

- 1 Unique thread pattern** condenses bone during implant insertion.
- 2** Implant body narrows conically, while outer thread diameter of the cylinder remains the same, facilitating **immediate stability**.
- 3** Sharp apical cutting notch facilitates self-tapping function and allows for final **implant placement by hand**.
- 4** 3.5mm **deep internal hex connection** for anti-rotation safety of the prosthetic components.

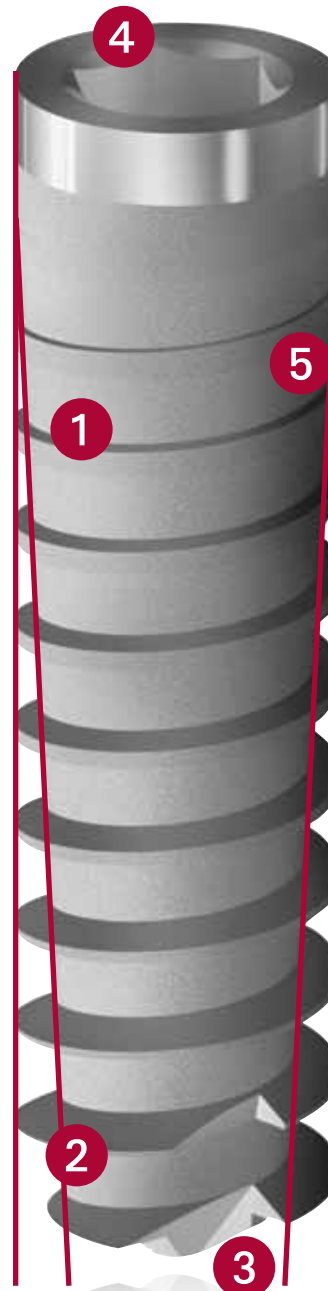

- 5** Implants are available in Puretex® or V-TPS Surface.

Puretex is the new dimension in implant surface treatment that provides a proprietary, subtractive nano-type surface for enhanced osseointegration and a strong bone-to-implant interface.

The V-TPS coating greatly increases the implant surface area for contact osteogenesis and enhanced osseointegration. The vacuum process generates a homogeneous, niche-free deposition layer by permanently bonding very fine particles to the implant surface.

Implant Sizes

Implant Diameter	Color Coding	Implant Lengths (2mm increments)
3.25 mm	Green	8-16 mm
3.75 mm	Yellow	8-16 mm
4.00 mm	Red	8-16 mm
4.90 mm	Blue	8-14 mm
6.50 mm	Grey	10-14 mm



"With Pitt-Easy I feel completely confident that immediate stability can be achieved in all bone types, even with fresh extractions. Pitt-Easy has become my number one threaded implant of choice"

*Dr. James Rutkowski
General Practitioner, Clarion, PA, USA*

Abutment Selections

For the Ultimate Esthetic Restoration

Anatomic Temporary Abutment

A tooth colored acrylic temporary abutment, with a built-in gingival shoulder is ideal for gingival moulding and fabrication of temporary crowns.



Locator® Abutment System

The Locator has an extremely low profile, a self-aligning feature which aids patients in seating their denture, and a dual retention feature for long-lasting durability – all resulting in fewer maintenance visits! The Locator’s minimal vertical height is ideal for all overdenture patients – cases with angulation problems and limited occlusal space can be easily corrected.



UCLA Abutment

Indicated for screw-retained or cemented restorations, the base of this UCLA style abutment consists of a machined gold-platinum, so that all precious metal alloys can be used for a cast-on method.



Ball Head Abutment System

The unique design of the ball head abutment facilitates both O-Ring and Dalbo®-Plus attachment systems.

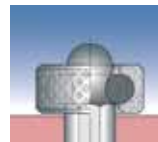

O-Ring System



Dalbo®-Plus System

Cerabond® Abutment

This gold colored, contoured abutment is ideal for direct veneering of ceramic material.



Anatomic Abutments

For ideal esthetics, the shoulder on the anatomic abutment is lower on the buccal and slightly ascends towards the lingual, facilitating a clearly defined crown margin. The subgingival design of this abutment allows individual adjustment to the gingival contour as well as an adjustment to the anatomical direction of the tooth. Abutments are available in straight, 15° and 25° angulations.

Version A

Version B



PATENTED



Version A

The Angulation of the abutment is oriented to the flat side of the hex.



Version B

The Angulation of the abutment is oriented to the corner of the hex.



Headquarters

1717 West Collins Avenue
Orange, California 92867 USA
T 714.516.7800
F 714.516.7866

International

Europe

Sybron Implant Solutions GmbH
Julius-Bamberger-Str. 8a
28279 Bremen Germany
T 49.421.43939.0
F 49.421.443936

United Kingdom

Sybron Implant Solutions U.K.
4 Flag Business Exchange
Vicarage Farm Road
Peterborough, UK PE1 5TX
T 00.8000.841.2131
F 44.1733.891.299

France

Sybron Implant Solutions France
16 Rue Du Sergent Bobillot
93100 Montreuil
T 33.149.88.60.85
F 33.149.88.60.86

Australia

Sybron Implant Solutions Pty
Unit 10, 112-118 Talavera Road
North Ryde, NSW 2113
T 61.2.8870.3099
F 61.2.8870.3088